

GAS MAIN PIPELINE PN25



MONOLITHIC ISOLATION JOINTS | Engineered. Safe. Durable.

Giunti isolanti di linea

Classe: **PN25 / MOP25**

Applicazioni principali:
Trasporto e distribuzione di GAS (UNI EN 1594), reti di distribuzione (UNI 9165), impianti di derivazione del gas (UNI 9860).

Main pipeline isolation joints

Class: **PN25 / MOP25**

Main applications:
Gas supply system (UNI EN 1594), gas distribution network (UNI 9165), gas service pipe (UNI 9860).



T	R	RT	RP	P		
70°C	>100 Mohm	5 KV	>10 KV	25 Bar 2.5 MPa	T=Max temperatura di esercizio R=Resistenza di isolamento in aria a 1000 Volt c.c. RT=Tensione elettrica di prova c.a. RP=Tensione elettrica di perforazione c.a. P=pressione nominale	T=Max operating temperature R=Electric resistance in air at 1000 Volt d.c. RT=Dielectric test a.c. RP=Dielectric strength c.a. P=Nominal pressure
	U.R.=55% t=22°C (prove di officina/ factory tests)					

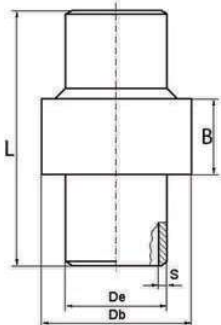

Certificazione
Certificates

- ✓ EN10204 3.1
- ✓ EN-UNI-CEI 17050-1
- ✓ CE conformity

ND	DN	De	Materiale tubo Pipe pups mat.	S	L	Db	B	Tipo Type	!
1/2"	15	21.3	Gr.B/L245	3.6	230	49	34	B3	(*)
3/4"	20	26.7	Gr.B/L245	3.9	245	51	35	B3	(*)
1"	25	33.4	Gr.B/L245	3.4	250	67	50	F1/C	(*)
1 1/4"	32	42.4	Gr.B/L245	3.6	300	76	50	F1	(*)
1 1/2"	40	48.3	Gr.B/L245	3.6	300	83	58	F1	(*)
2"	50	60.3	Gr.B/L245	3.9	350	88	60	NG5/C	(*)
2 1/2"	65	76.1	L245	4.8	350	113	65	NG5/C	(*)
3"	80	88.9	Gr.B/L245	4.8	400	125	65	NG5/C	-
4"	100	114.3	Gr.B/L245	4.8	400	150	75	NG5/C	-
5"	125	141.3	Gr.B/L245	4.8	500	191	92	NG5/C	-
6"	150	168.3	Gr.B/L245	5.6	500	215	97	NG5/C	-
8"	200	219.1	Gr.B/L245	6.4	500	273	106	NG5/C	-
10"	250	273	Gr.B/L245	6.4	700	323	116	NG5/C	-
12"	300	323.8	Gr.B/L245	6.4	700	382	154	NG5/C	-
14"	350	355.6	Gr.B/L245	7.1	900	426	180	NG5/B3	-
16"	400	406.4	Gr.B/L245	7.1	900	470	175	NG5/B3	-
18"	450	457.2	Gr.B/L245	7.1	900	518	200	NG5/B	-
20"	500	508	Gr.B/L245	7.1	1000	605	220	NG4/B	-
22"	550	558.8	Gr.B/L245	8	1000	660	234	NG4/B	-
24"	600	609.6	Gr.B/L245	8.8	1000	726	255	NG4/B	-
26"	650	660.4	Gr.B/L245	8.8	1000	766	255	NG4/B	(*)
28"	700	711.2	Gr.B/L245	8.8	1200	830	280	NG4/B	(*)
30"	750	762	Gr.B/L245	8.8	1200	870	280	NG4/B	(*)
In.	mm	Dimensioni in mm / Dimensions in mm							

(*): Diametro non previsto nella UNI 10285.
Tipo: vedi pubblicazione NG-IJTY-01.
Le dimensioni di ingombro, le foto e le figure sono a solo titolo indicativo.

(*) Item not provided in UNI 10285.
Type: please refer to Nuovagiungas publication NG-IJTY-01.
Overall dimensions, drawings and images for illustrative purpose only.

Materiale: Acciaio API 5L / ISO 3183 / EN10208-2
Estremità a saldare: API 5L / ISO 3183 / EN10208-2
(smusso= 30° + 5/-0°; spalla= 1.6mm)
Norme e codici: NACE SP0286-86,
2014/34/UE - Atex - II 2 GD Zona 1 e
21 d T6
A richiesta: 2014/68/UE (PED)

Materials: Steel API 5L / ISO 3183 / EN10208-2
Weld ends: API 5L / ISO 3183 / EN10208-2
(bevel= 30° + 5/-0° root= 1.6mm +/-0.8mm)
Rules and norms: NACE SP0286,
2014/34/UE - Atex - II 2 GD Zona 1 e
21 d T6
Upon request: 2014/68/UE (PED)