

MAIN PIPELINE PN100



MONOLITHIC ISOLATION JOINTS | *Engineered. Safe. Durable.*

Giunti isolanti di linea PN100

Classe: **PN100 / MOP100**

Applicazioni principali:
Trasporto e distribuzione di GAS, reti di distribuzione gas, acqua ed altri fluidi^(*), impianti.

(*) La lista dei fluidi compatibili disponibile a richiesta

Main pipeline isolation joints PN100

Class: **PN100 / MOP100**

Main applications:
Gas supply system, gas, water or other fluids^(*) distribution network, plant.

(*) Allowed fluid available upon request



T	R	RT	RP	P	T=Max temperatura di esercizio R=Resistenza di isolamento in aria a 1000 Volt c.c. RT=Tensione elettrica di prova c.a. RP=Tensione elettrica di perforazione c.a. P=pressione nominale	T=Max operating temperature R=Electric resistance in air at 1000 Volt d.c. RT=Dielectric test a.c. RP=Dielectric strength c.a. P=Nominal pressure
70°C	>100 Mohm	5 KV	>10 KV	100 Bar 10,0 MPa		
	U.R.=55% t=22°C (prove di officina/ factory tests)					

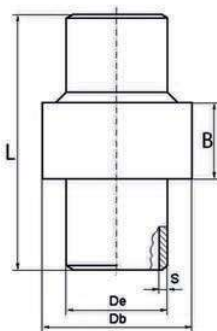

Certificazione
Certificates

- ✓ EN10204 3.1
- ✓ EN-UNI-CEI 17050-1
- ✓ CE conformity

ND	DN	De	Materiale tubo Pipe pups mat.	S	L	Db	B	Tipo Type
1/2"	15	21.3	Gr.B/L245	3.2	250	60	59	F2(F1)
3/4"	20	26.7	Gr.B/L245	3.2	250	65	60	F2(F1)
1"	25	33.4	Gr.B/L245	3.4	250	75	60	F1(F2)
1 1/4"	32	42.4	Gr.B/L245	3.6	300	83	68	F2(F1)
1 1/2"	40	48.3	Gr.B/L245	3.7	300	95	86	F1(F2)
2"	50	60.3	Gr.B/L245	3.9	350	114	104	NG5/C
2 1/2"	65	76.1	L245	5.5	350	132	117	NG5/C
3"	80	88.9	Gr.B/L245	5.5	500	155	123	NG5/C
4"	100	114.3	Gr.B/L245	6	500	190	128	NG5/C
5"	125	141.3	Gr.B/L245	6.5	600	217	148	NG5/C
6"	150	168.3	X52/L360	7.1	600	248	161	NG5/C
8"	200	219.1	X52/L360	8.2	600	297	183	NG5/C
10"	250	273	X52/L360	9.3	800	364	202	NG5/C
12"	300	323.8	X52/L360	9.5	800	430	223	NG5/C
14"	350	355.6	X52/L360	12.7	1000	455	231	NG4/B
16"	400	406.4	X52/L360	12.7	1000	540	280	NG4/B
18"	450	457.2	X52/L360	14.3	1000	600	290	NG4/B
20"	500	508	X52/L360	15.9	1200	684	308	NG4/B
22"	550	558.8	X52/L360	17.5	1200	730	340	NG4/B
24"	600	609.6	X52/L360	19	1200	810	360	NG4/B
26"	650	660.4	X52/L360	19	1200	845	390	NG4/B
28"	700	711.2	X52/L360	19	1300	890	400	NG4/B
30"	750	762	X52/L360	19	1300	970	421	NG4/B
In.	mm	Dimensioni in mm / Dimensions in mm						

Tipo: vedi pubblicazione NG-IJTY-01.
Le dimensioni di ingombro, le foto e le figure sono a solo titolo indicativo.

Type: please refer to Nuovagiungas publication NG-IJTY-01.
Overall dimensions, drawings and images for illustrative purpose only.

Materiale: Acciaio API 5L / ISO 3183 / EN10208-2
Estremità a saldare: API 5L / ISO 3183 / EN10208-2
(smusso= 30° + 5/-0°; spalla= 1.6mm)
Norme e codici: NACE SP0286-86,
2014/34/UE - Atex - II 2 GD Zona 1 e
21 d T6
A richiesta: 2014/68/UE (PED)

Materials: Steel API 5L / ISO 3183 / EN10208-2
Weld ends: API 5L / ISO 3183 / EN10208-2
(bevel= 30° + 5/-0° root= 1.6mm +/-0.8mm)
Rules and norms: NACE SP0286,
2014/34/UE - Atex - II 2 GD Zona 1 e
21 d T6
Upon request: 2014/68/UE (PED)